



# INSTRUCTION BULLETIN

No. 9006742  
Machine: 800 / 810  
Published: 11-2009  
Rev. 01

**NOTE: DO NOT DISCARD the Parts List from the Instruction Bulletin. Place the Parts List in the appropriate place in the machine manual for future reference. Retaining the Parts List will make it easier to reorder individual parts and will save the cost of ordering an entire kit.**

*NOTE: Numbers in parenthesis ( ) are reference numbers for parts listed in Bill of Materials.*

Installation instructions for **kit number 9006741**

## SYNOPSIS:

This kit contains the parts needed to install the radiator fan shroud kit on 800 (serial numbers 007000-007400) / 810 machines (serial numbers 004500-005047).

Please follow step-by-step instructions.

## SPECIAL TOOLS / CONSIDERATIONS: NONE

(Estimated time to complete: 3 hours)

## PREPARATION:

1. Park the machine on a clean level surface, turn off the machine, remove the key, and set the parking brake.

**FOR SAFETY: Before leaving or servicing machine, stop on level surface, turn off machine, and remove key.**

2. Open both the engine side door and engine cover to access the engine.

3. Remove the lower access panel from the operator compartment. Set the panel and hardware aside. Refer to Fig. 1.

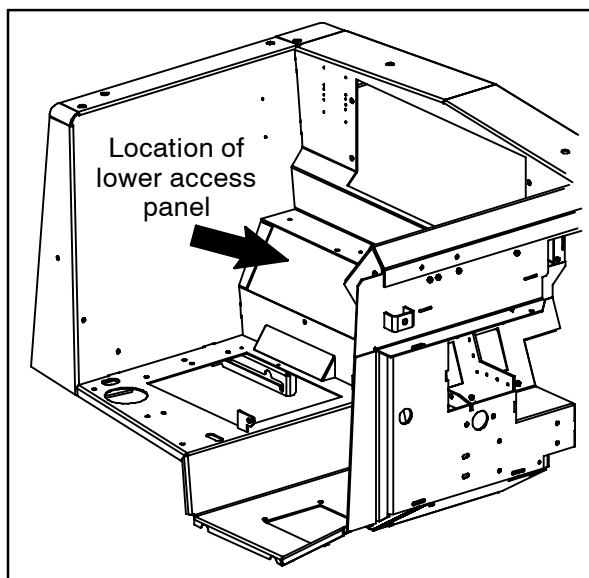
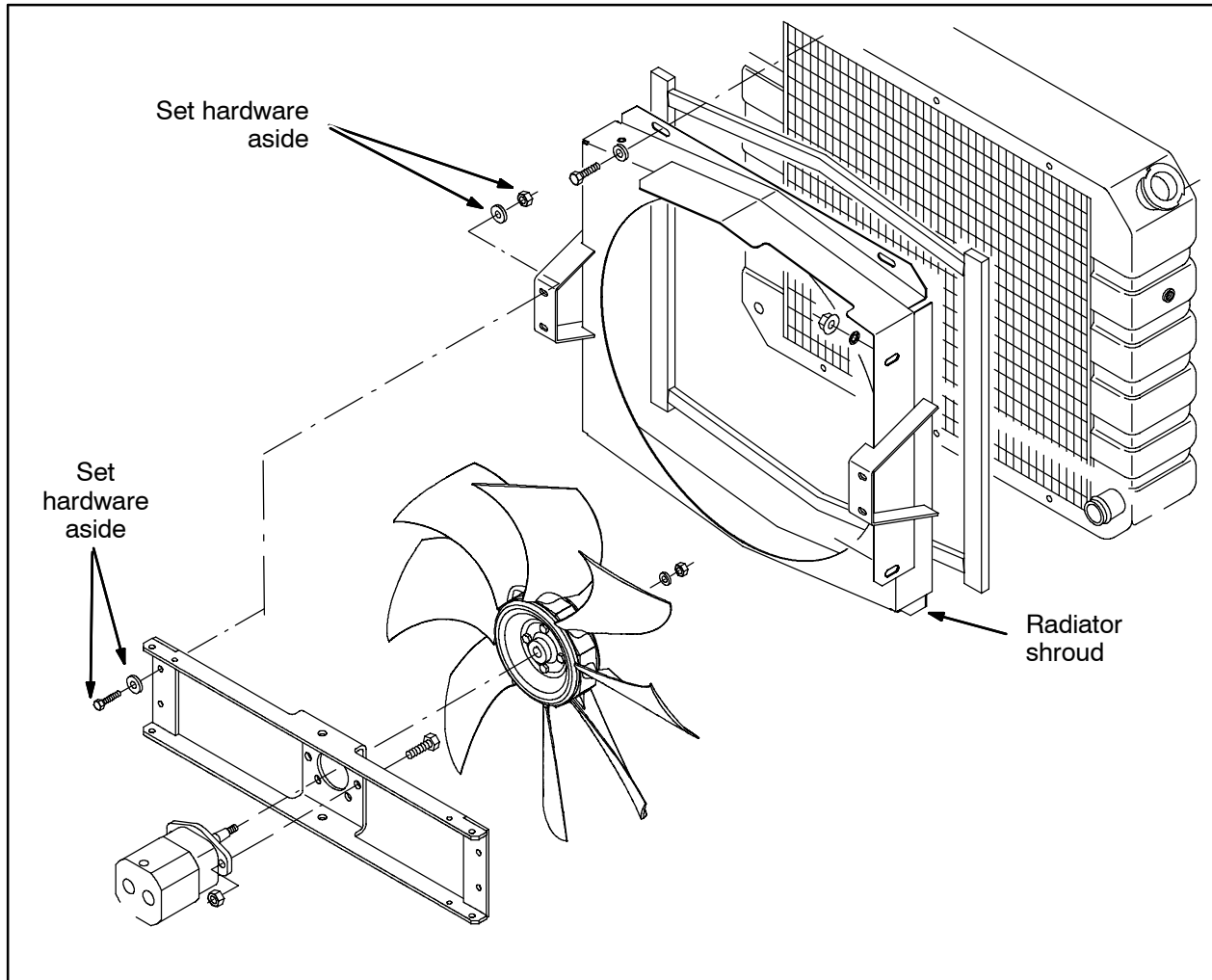

FIG. 1

## INSTALLATION:

1. Remove any components necessary to make removing the fan motor bracket and radiator shroud easier. Set all removed components and hardware aside.
2. Remove the fan motor bracket from the radiator shroud. Set all mounting hardware aside. Refer to Fig. 2.



**FIG. 2**

3. Remove the fan from the fan hydraulic motor. Set the fan and mounting hardware aside. Refer to Fig. 3.

4. Remove the fan hydraulic motor from the fan motor bracket. Carefully set the hydraulic motor out of the way inside the engine compartment. **Do Not** disconnect hydraulic hoses / fittings when removing the hydraulic motor from the bracket. Set all mounting hardware aside. Discard the fan motor bracket. Refer to Fig. 3.

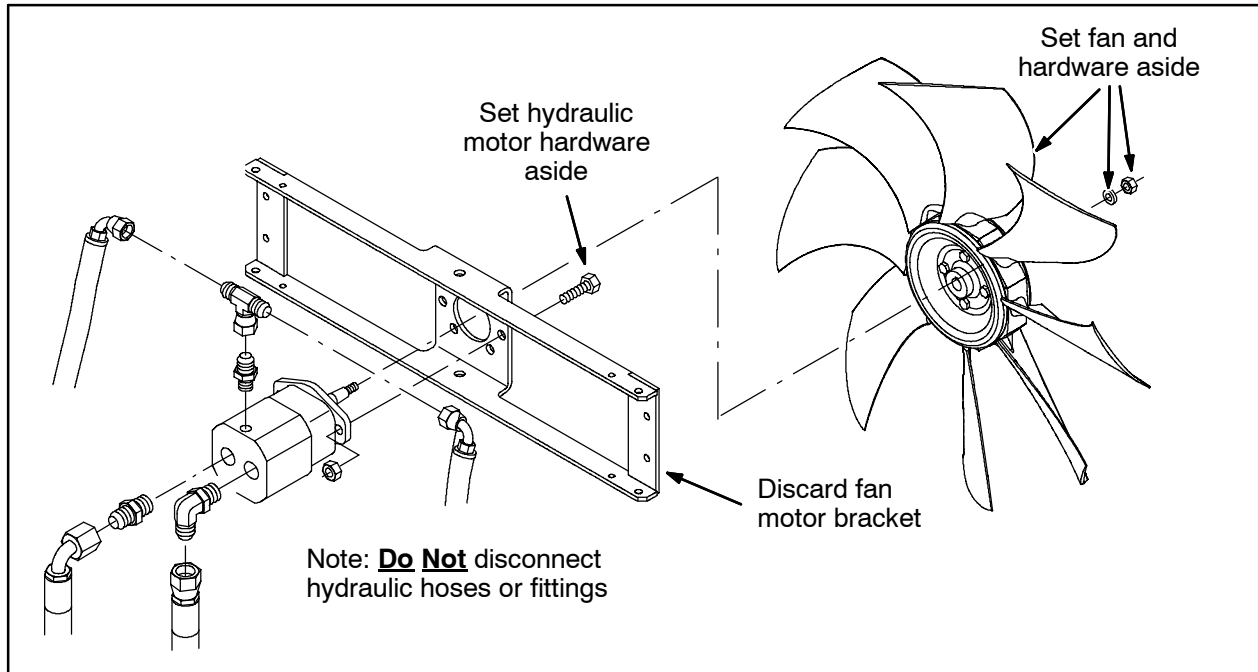

FIG. 3

5. Remove the radiator shroud from the radiator. Set all mounting hardware aside. Discard the radiator shroud. Refer to Fig. 4.

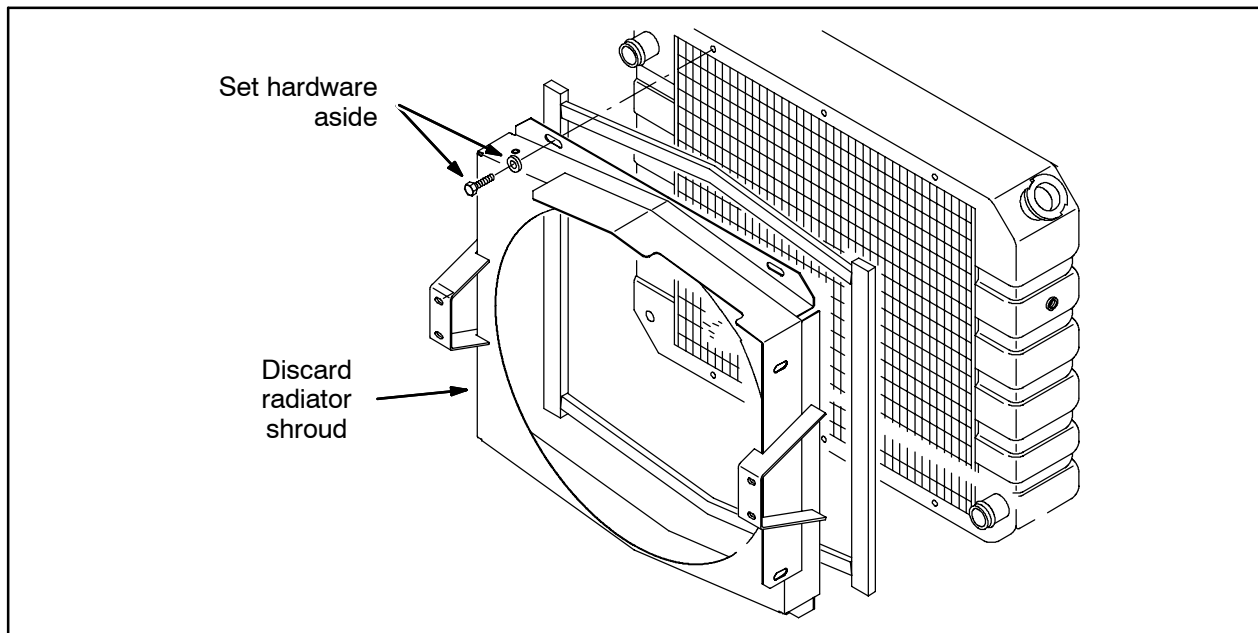

FIG. 4

6. Drill two 0.276" (7.00 mm) holes into the operator station side panel. Refer to Fig. 5.

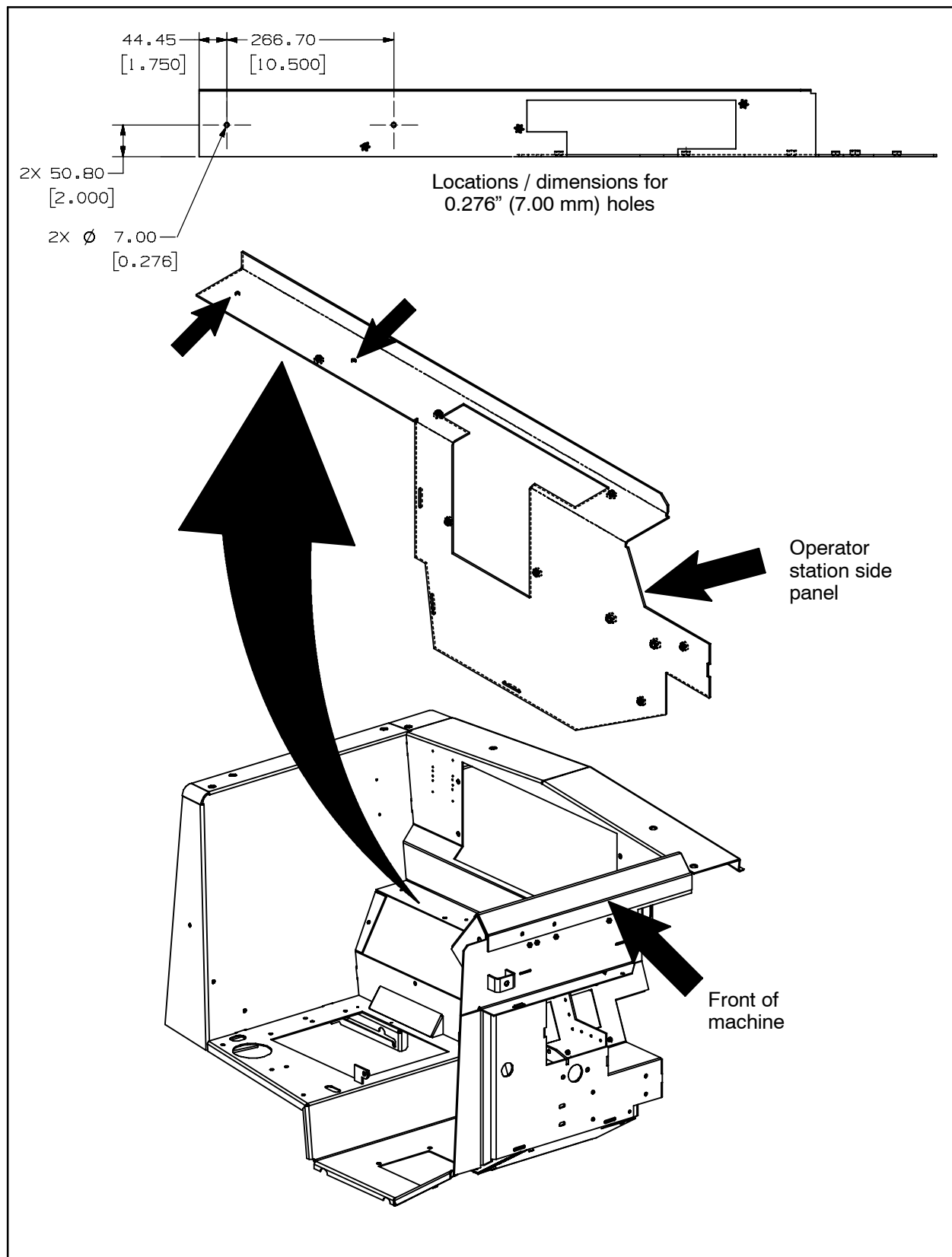
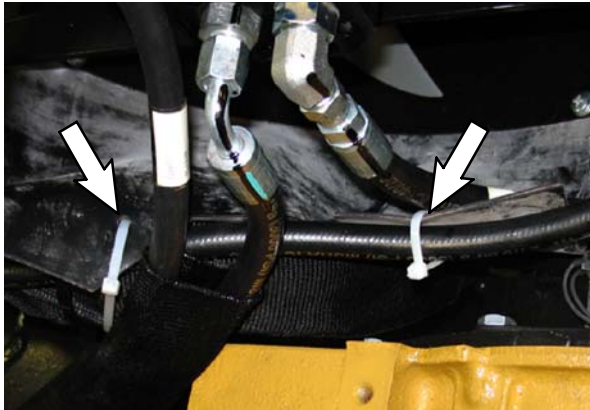

FIG. 5

7. Install both 19" urethane (8) seals onto the new radiator fan shroud (1). Refer to Fig. 9.
8. Use three pan screws (3), three flat washers (5), and three hex nuts (6) to secure the cooling fan skirt (2) to the radiator shroud (1). Refer to Fig. 9.
9. Install the radiator shroud (1) onto the radiator. Refer to Fig. 4.
10. Use a cable tie (9) to secure the cooling fan skirt (2) to the drive hydraulic hoses. Tighten the cable tie just enough to hold the skirt into place. Do not completely tighten the cable tie. Refer to Fig. 6.



**FIG. 6**

11. Use a cable tie (9) to secure the cooling fan skirt (2) to the vacuum fan hydraulic hose. Tighten the cable tie just enough to hold the skirt into place. Do not completely tighten the cable tie. Refer to Fig. 6.
12. Use two pan screws (3), two flat washers (5), and two hex nuts (6) to secure the cooling fan skirt (2) to the bottom of the operator station side panel where the two 0.276" (7.00 mm) holes were drilled. Refer to Fig. 7 and Fig. 9.

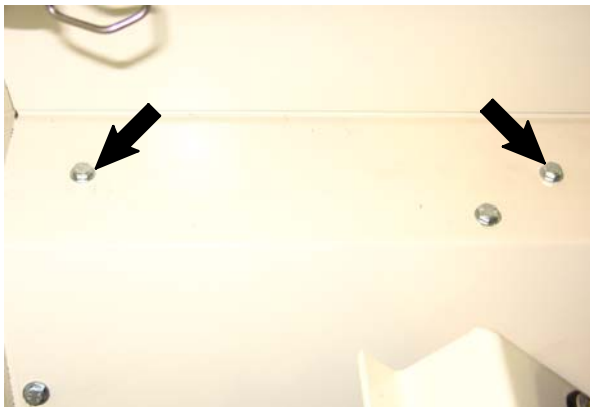

**FIG. 7**

13. Install the fan hydraulic motor onto the new hydraulic motor mounting bracket (7). Refer to Fig. 3.
14. Reinstall the fan onto the hydraulic motor. Refer to Fig. 3.
15. Install the cooling fan assembly assembled in the previous two steps onto the radiator shroud (1).
16. Use a hex screw (4), flat washer (5), and hex nut (6) to secure the cooling fan skirt (2) to the hydraulic motor mounting bracket (7). Refer to Fig. 8 and Fig. 9.



**FIG. 8**

17. Reassemble / reinstall any parts removed from the machine prior to installing the radiator fan shroud kit.
18. Start and run machine. Observe the cooling fan skirt (2). The cooling fan skirt should remain securely in place and not be sucked up into the fan while the machine is operating.

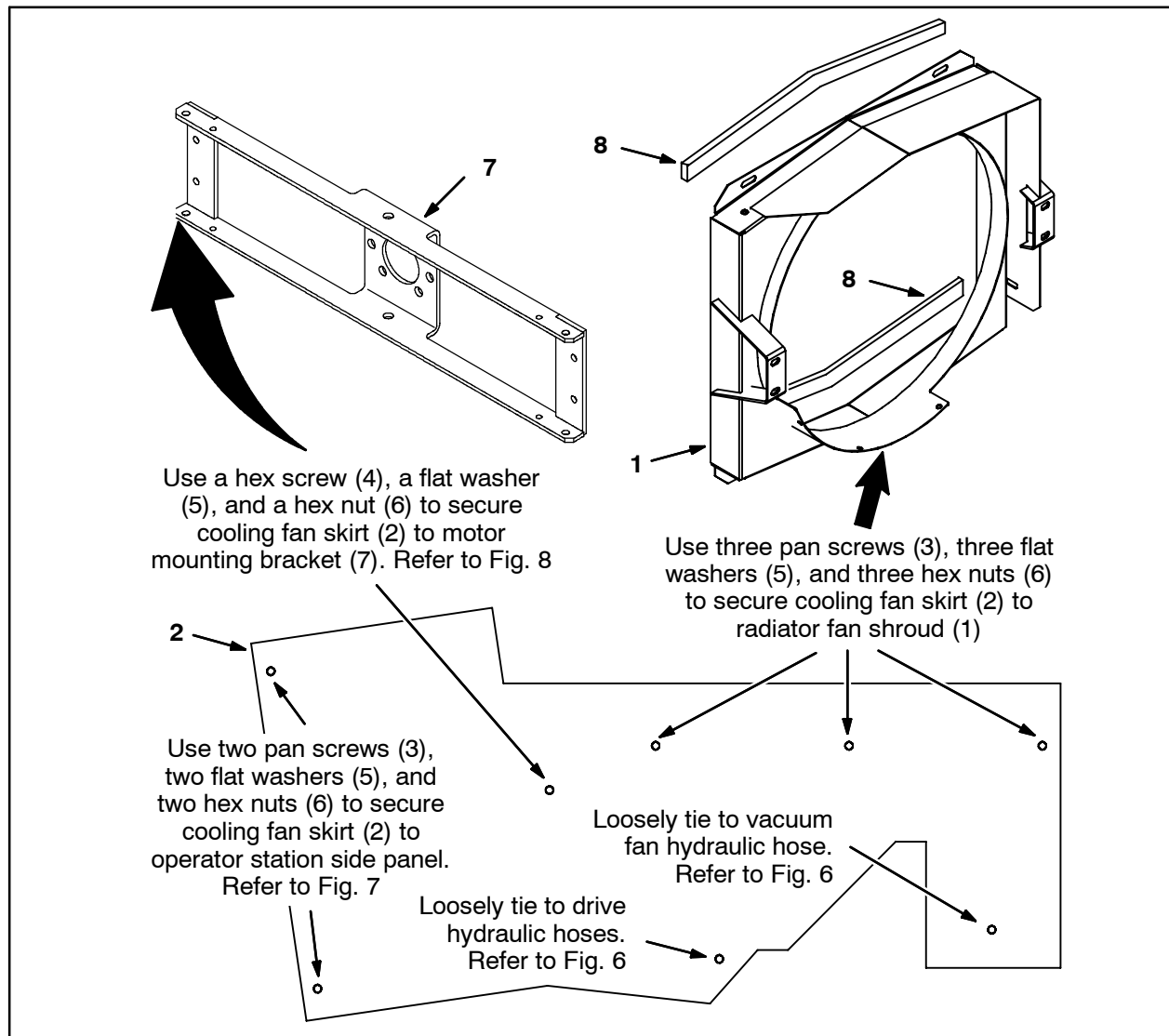

**FIG. 9**

**Bill of Materials for Shroud Kit, Fan, Radiator [800/810] - 9006741**

Ref.	Tennant Part No.	Description	Qty.
▽	9006741	SHROUD KIT, FAN, RADIATOR [800/810]	1
▲	1 1056213	SHROUD WLDT, FAN, RADIATOR [800/810]	1
▲	2 1055893	SKIRT, COOLING FAN [800/810]	1
▲	3 09145	SCREW, PAN, PHL, M6 X 1.00 X 16, 4.8	5
▲	4 06943	SCREW, HEX, M6 X 1.00 X 20, 8.8	1
▲	5 32490	WASHER, FLAT, 0.25, STD	6
▲	6 08708	NUT, HEX, LOCK, M6 X 1.00, NL	6
▲	7 1051599	BRACKET WLDT, MTG, MOTOR	1
▲	8 374230	SEAL, URE, 0.38, 0.75W 19.5L ADH	2
▲	9 763114	TIE, CABLE, 11.3L, 2.75D MAX	2

TENNANT COMPANY  
P. O. Box 1452  
Minneapolis, MN 55440-1452